

1 KEY PLAN
SCALE: N/A

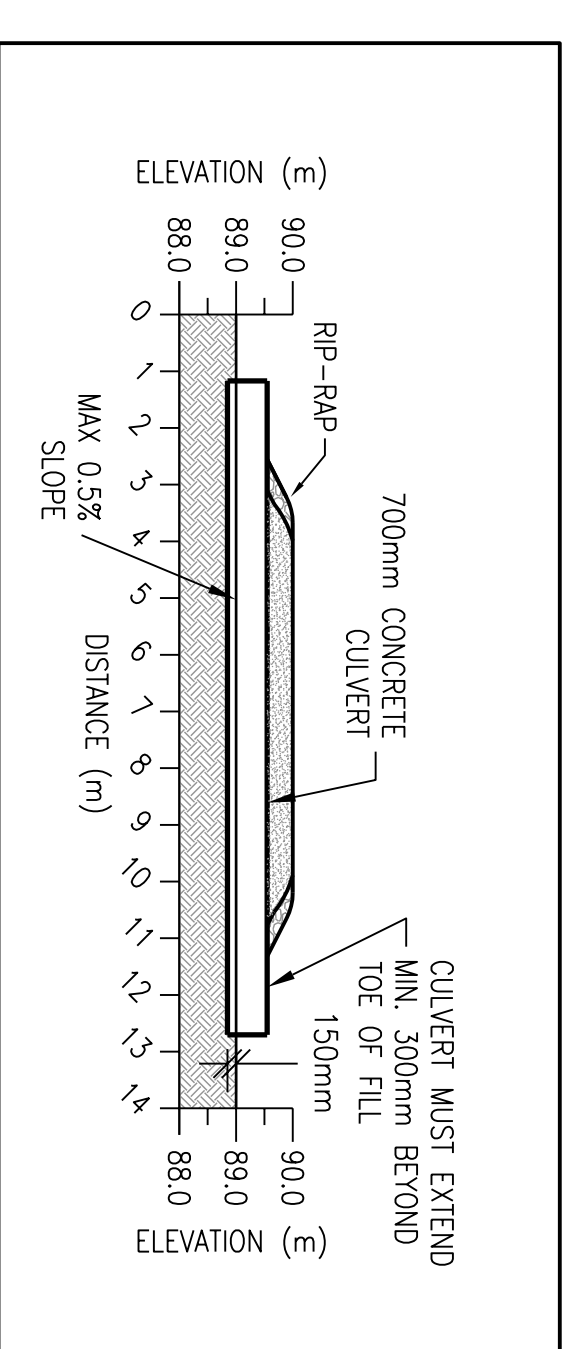

2 CULVERT DETAIL
SCALE: N/A

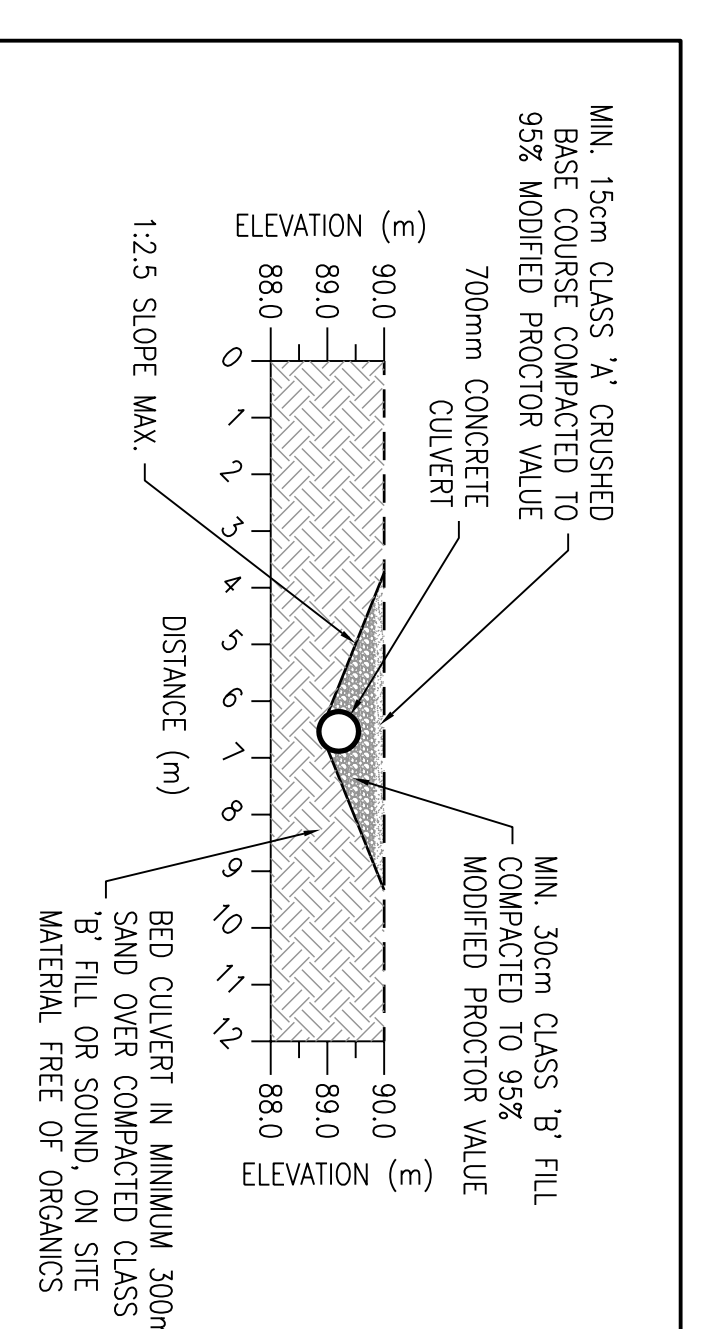

3 CULVERT DETAIL
SCALE: N/A

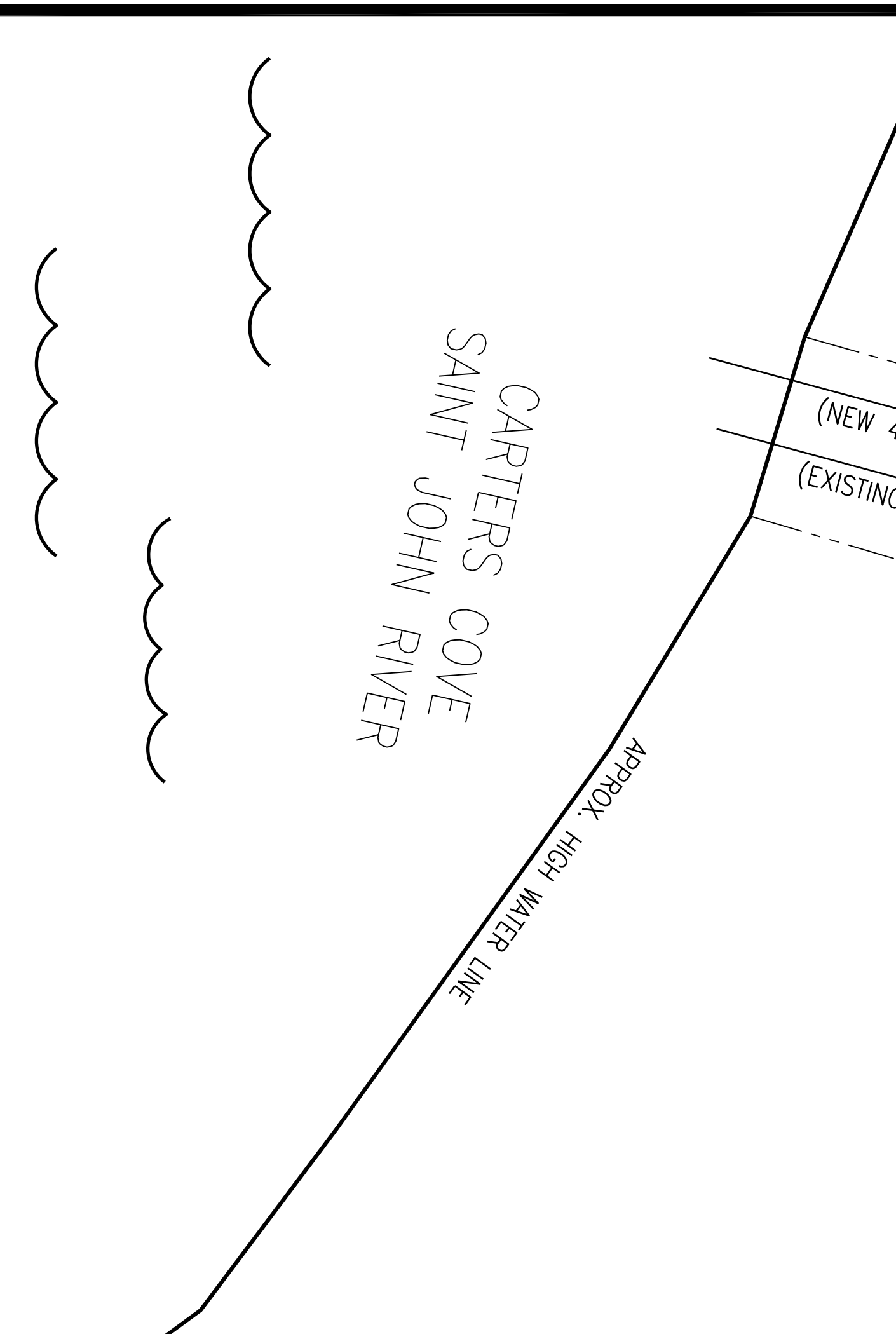
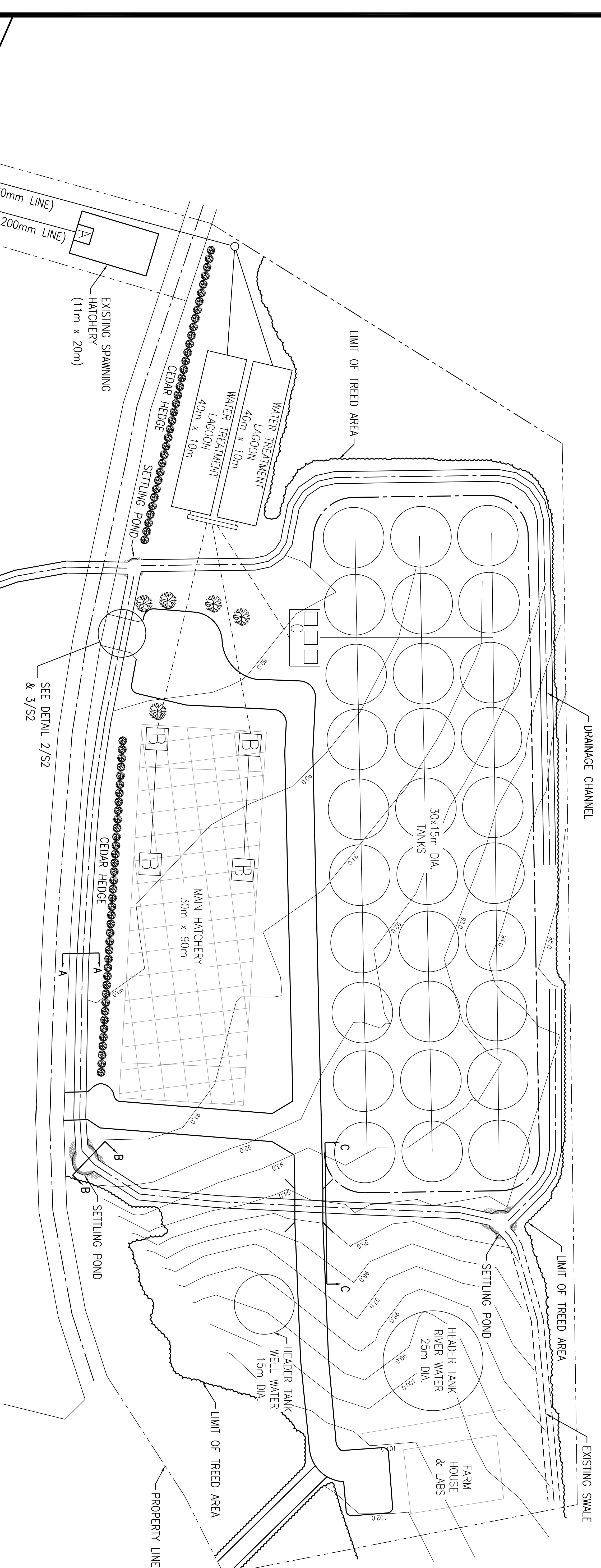

4 SITE PLAN
SCALE: 1:500

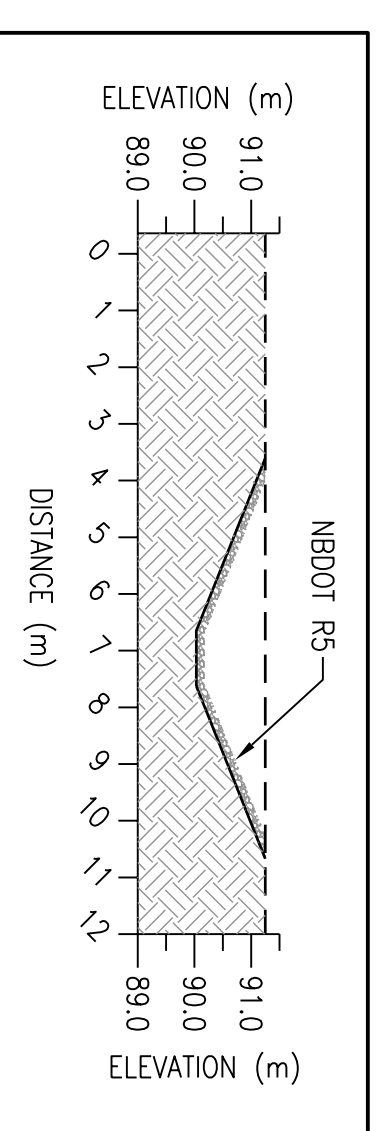

5 CROSS SECTION A-A
SCALE: N/A

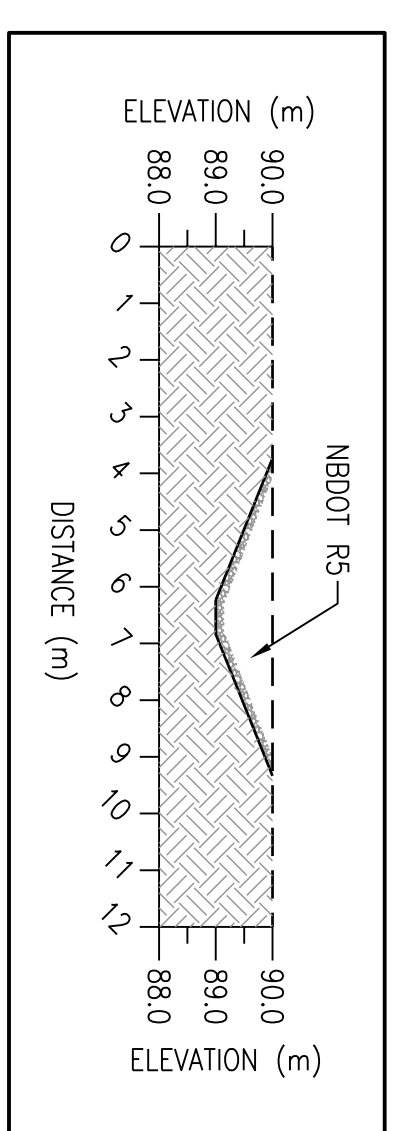

6 CROSS SECTION B-B
SCALE: N/A

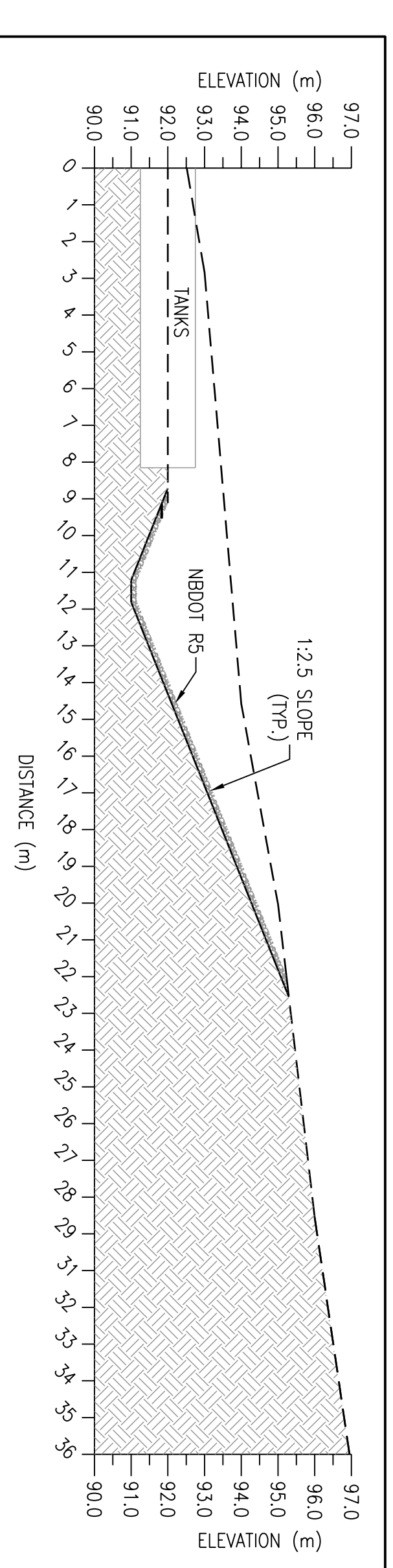

7 CROSS SECTION C-C
SCALE: N/A

FILTER SCHEDULE

I.D.	PHYSICAL COMPONENTS	TOTAL WATER SURFACE (CUM/MH)	MAX FLOW (CUM/MH)	TEMP (C)	INLET PERMIT		OUTLET PERMIT		TECHNOLOGY/EQUIPMENT							
					mm BOD (mg/L)	mm TP (mg/L)	mm BOD (mg/L)	mm TP (mg/L)								
A	SPAWNING HATCHERY	220	71.40	35.46	14-20	10	20	10	0.1	0.15	0.2	0.1	0.1	0.1	0.1	0.1
B	MAIN HATCHERY	2865	1,148.60	125.37	5-20	10	20	10	20	20	20	20	20	20	20	20
C	GROUND AREA	8,250	5,298.75	537.19	2-20	10	20	10	20	20	20	20	20	20	20	20

0.2% SLOPE (MINIMUM 300mm SAND OVER COMPACTED CLASS B' FILL OR SAND, ON SITE MATERIAL FREE OF ORGANICS)
 1.25% SLOPE MAX.
 MIN. 300mm CLASS B' FILL COMPACTED TO 95% MODIFIED PROCTOR VALUE
 MIN. 150mm CLASS A CRUSHED BASE COURSE COMPACTED TO 95% MODIFIED PROCTOR VALUE
 700mm CONCRETE CULVERT
 MIN. 150mm CLASS A CRUSHED BASE COURSE COMPACTED TO 95% MODIFIED PROCTOR VALUE
 1.25% SLOPE MAX.

8 FILTER SCHEDULE
SCALE: N/A

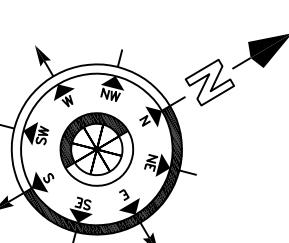
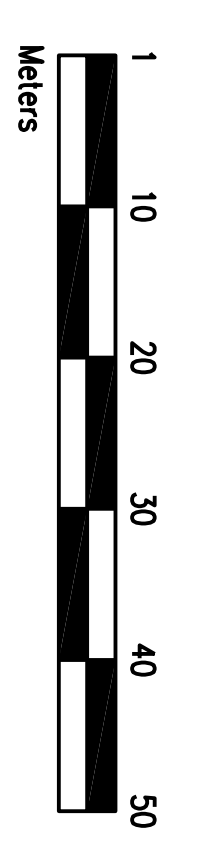

General Notes
 1) ELEVATIONS SHOWN ARE RELATIVE
 2) THIS SITE PLAN IS BASED UPON
 NBDC MAPPING AND DOES NOT
 CONSTITUTE A LEAK SURVEY

No.	Revision/Issue	Date

FUNDY Engineering

31 Dorchester St.
 P.O. Box 6628
 Saint John, NB
 E2L 4S1
 (506) 452-1566
 Fax: 635-0266
 fundy@fundyeng.com
 www.fundyeng.com

Project:
**Acadian Sturgeon
 Sturgeon Farm
 and Gene Bank**

Drawn by:
**Drainage and
 Sediment Control Plan**

Drawn: PML
 Date: MARCH 20, 2006
 Scale: AS NOTED
S2